

OEM 5/8" Between the Glass Metal Blind Series P2625

oem 

S H A D E S INC.

700 First Avenue, Ford City, PA 16226

Phone: 724-763-3600 • Fax: 724-763-3601

www.oemshades.com

Included:

Specifications

Overview Diagram

Head Cable Diagram

Mini Removable Key Operator Diagram

Removable Key Operator Diagram

Standard Knob Operator Diagram

Warranty Information

Order Form

OEM 5/8" Between Glass Metal Blind Series P2625

Specifications

1. General

(a) Work Included

Provide all labor, material and equipment necessary to furnish metal blinds and components as specified.

(b) Description

1. Metal blinds shall have nominally 5/8" (15mm) wide horizontal slats supported by braided ladders.
2. It shall be possible to position the slats to any horizontal angle by means of a tilt control knob.
3. The slats shall have the ability to be raised and lowered by the means of lift cords.
4. Components shall be various brands as manufactured by OEM Shades Inc.
5. Standard colors are used on components of the blind that are visible.
6. Any sharp edges, burrs or other defects that may be harmful to the operation or to persons or materials in contact with them shall be removed by the manufacturer.
7. Current OEM Shades Inc. standards and specifications will be used where workmanship, details and procedures are concerned.

(c) Submittals

1. **Manufacturers Product Data:** Submit manufacturer's product data and installation guidelines.
2. **Samples**
 - i. Samples of product may be furnished upon request with a cost to the customer.
 - ii. Color samples shall be provided for final approval.

(d) Delivery, Storage and Handling

1. Blinds shall be packed, unloaded, stored and protected to avoid abuse and damage from any source.
2. Store inside in a clean, well-drained area free of dust until ready for installation.
3. When installing protect materials from acids, solvents abrasives and careless handling.

(e) Warranty

1. **Material**
 - i. Ten-year warranty on the material.
2. **Components**
 - i. Ten-year warranty on the headrail and other components that are defective in material and workmanship for the duration of the reasonable life (five years) of this product. Reasonable life assumes normal wear which excludes extended exposure to the outside environment when the blind is installed between screen and glass. (See specific warranty statement for details).

2. Product

(a) Materials

- (i) Slats shall be aluminum alloyed for maximum strength, flexibility and resistance to corrosion.
 1. Slats shall be 5/8" (15mm) wide, actual 0.600-inch (plus .005 minus .000-inch).
 2. Slats shall have a pre-coating treatment to bond the polyester baked enamel finished or powder coating. The finish includes dust and stain inhibitors for a durable finish. The minimum coating thickness shall be nominally 1.0 mil.
 3. A formed contour creates the finished crown with rounded corners tangent to the ends of the slat.
- (ii) Headrail shall be one piece consisting of 6063-T5 aluminum
 1. Size shall be 5/8" x 1 1/16"
 2. Exposed aluminum surfaces shall be coated with a baked polyester enamel finish or powder coated finish that shall coordinate with the color of the blind or existing window frame finish.
- (iii) Bottom rail shall be oval shaped aluminum extrusion (6063-T5).
 1. Size shall be 5/8" x 3/8".
 2. Exposed aluminum surfaces shall be coated with a baked polyester enamel finish or powder coating that shall coordinate with the color of the blind or existing window frame finish.
- (iv) End caps shall be made of nylon. They shall be formed to fit the profile of the extrusion and shall be held by a pressure fit.
- (v) Braided ladder shall be braided polyester Dacron yarn.
 1. Ends of the braided ladders shall be attached to fit securely around the tilt rod and bottom rail. Ladders shall not be spaced over 15 inches and not more than 6 inches from the ends of the slat.
- (vi) Lift cords consist of rayon core covered by a polyester Dacron jacket.
 1. Cords shall be .036-inch diameter.
 2. Lift ring shall be included with lift cord.
- (vii) Ladder locks shall be made of molded polyethylene to snap in and lock in the bottom rail.
- (viii) Braided ladder barrel and cradle.
 1. Braided ladder barrel shall be held by welding the ends and compressed tightly around the body of the ladder.
 2. The ladder shall be secured to the tilt rod in such a way to ensure tight closure of slats.
- (ix) Tape spacers made of clear non-yellowing polycarbonate shall be used for each ladder to provide proper tilting.
- (x) The tilt control system shall include a slip feature to prevent potential damage to the blind and the control knob due to over tilting.
 1. A zinc plated steel 1/8" D-shaped rod is centered within the nylon sleeves.
 2. The sleeve carrier, which supports the rod and sleeve assembly, shall be made of nylon. It shall include a feature that prevents the crossover of ladders, thus eliminating uneven slats.
 3. The tilt control cable assembly at the headrail shall consist of high flex cable with polyvinyl covers. It is assembled with aluminum fittings which accept the D-shaped rod to provide a direct drive tilt.
 4. The optional control rod cover shall be made of extruded polyvinyl and shall conceal the cable and D-rod connections.
 5. Nylon control knobs control the direction of the tilt. Cable driven control knobs shall have an anodized aluminum fitting which accepts the D-shaped rod to complete the direct drive tilt. Custodial tilt controls are also available in the various profiles.
- (xi) Installation brackets shall be provided with each blind.

1. Snap-in mounting brackets designed to fit the split headrail system shall be made of glass filled nylon. It shall include an edge locator feature to allow a 1/16" clearance from the glass. It shall also include a feature for easy removal of the headrail.
2. A minimum of two brackets are required with a maximum of four brackets on blinds up to 72" in width.

(b) Fabrication

(i) General

1. Blinds shall be completely fabricated, assembled and ready for fabrication.

(c) Options

- (i) Position of the tilter and lifter shall be selected by the customer under the blind size guidelines for installation.
- (ii) Available in 16 standard colors.

(3) Execution

(a) Inspection

- (i) Final inspection shall be made by the manufacturer before shipping.

(b) Installation

- (i) Installations shall be done by others.
- (ii) Instructions for installation shall be included.

(c) Cleaning

- (i) Clean soiled blind surfaces with a mild soap solution. Do not use steam, hot water or any abrasive or solvent based cleaners. Do not wash metallic colors.
- (ii) To ensure proper drying provide adequate ventilation for blinds. Remove bottom rail end caps and tilt headrail and bottom rail to drain water.

Specifications may change without notice.

OEM 5/8" Between Glass Metal Blind Series P2625
 Diagram

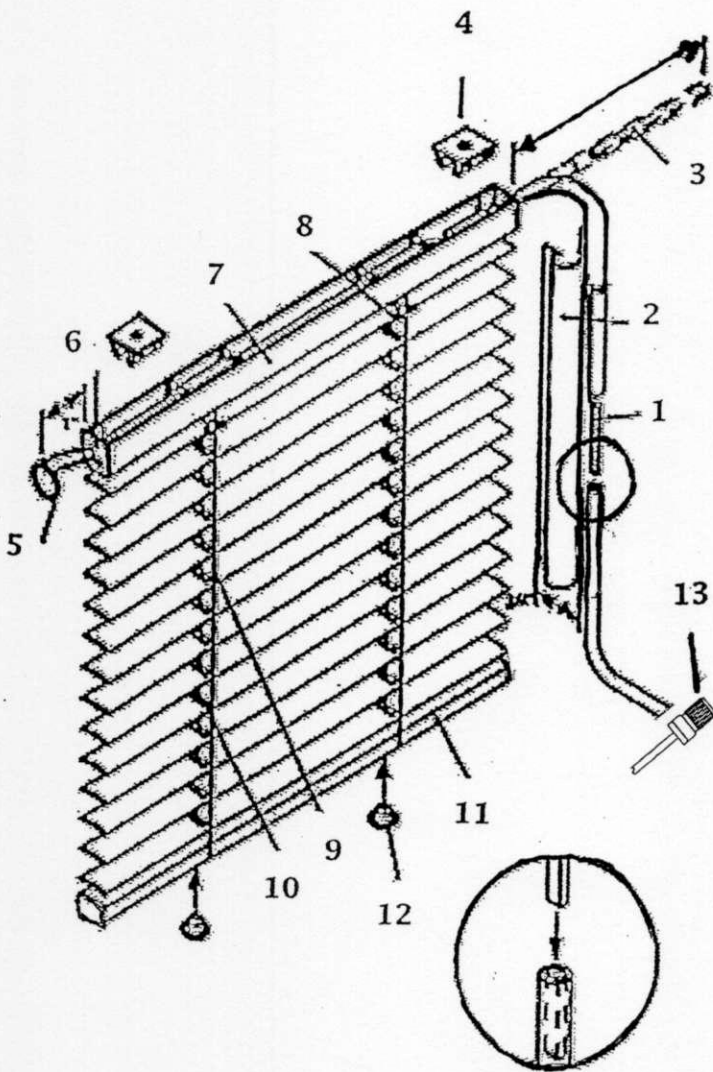

1. D-rod
2. Cover for D-rod: Black
3. 6 1/8" Headrail Cable Assembly
4. Installation Bracket
5. Lift Ring
6. Headrail Endcap
7. Extruded Aluminum Headrail
8. Tapespacer
9. Ladder 12/18-2T
10. Lift Cord 1.4mm
11. Sillrail
12. Sillrail Button
13. Straight Control Knob: Black

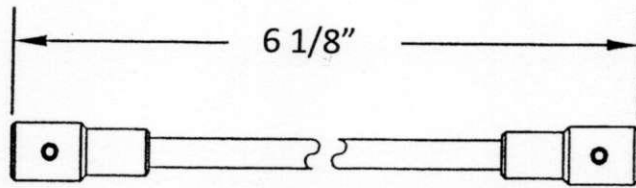

Head Cable

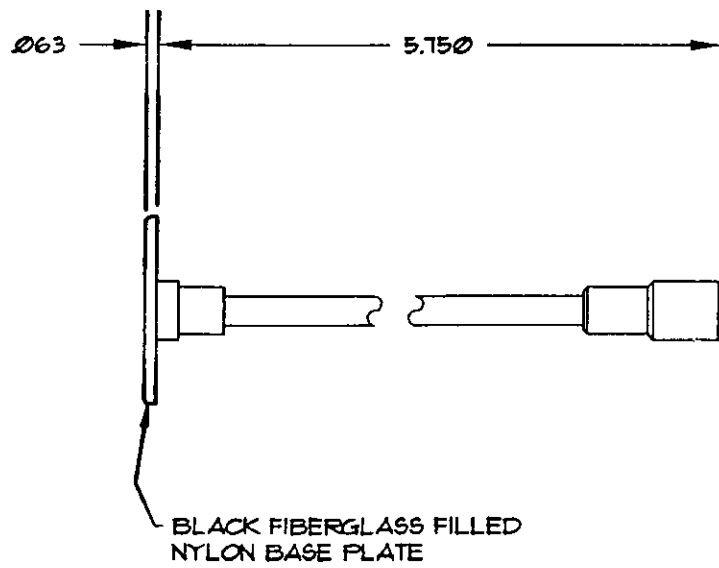
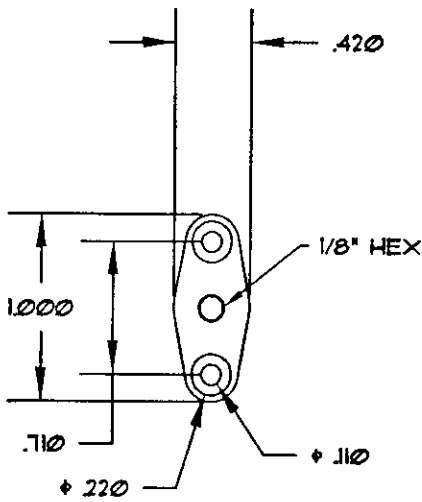
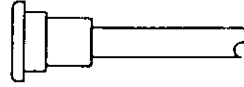

Mini Removable Key Operator

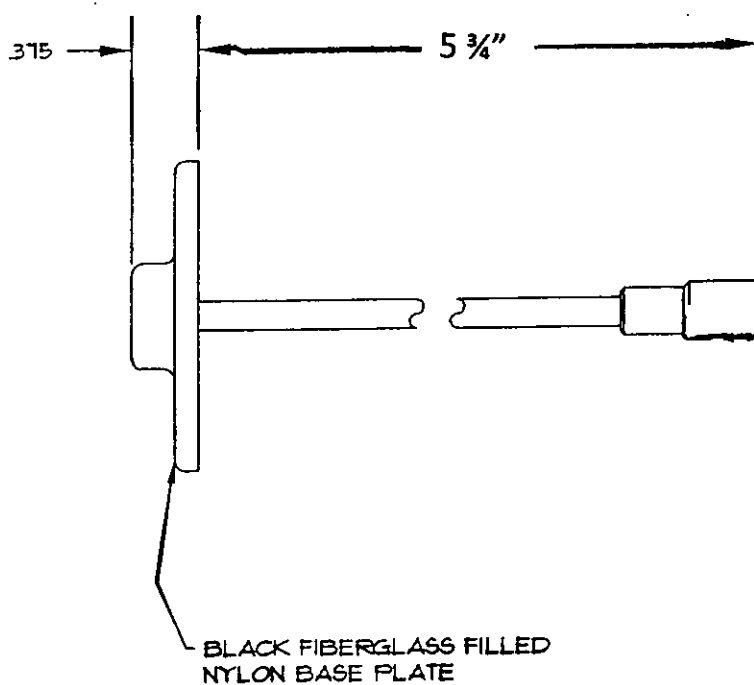
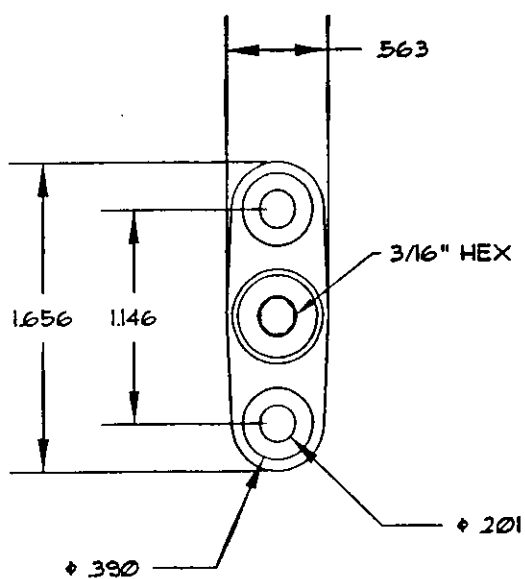
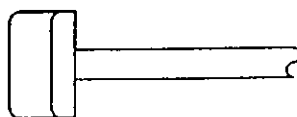

Removable Key Operator

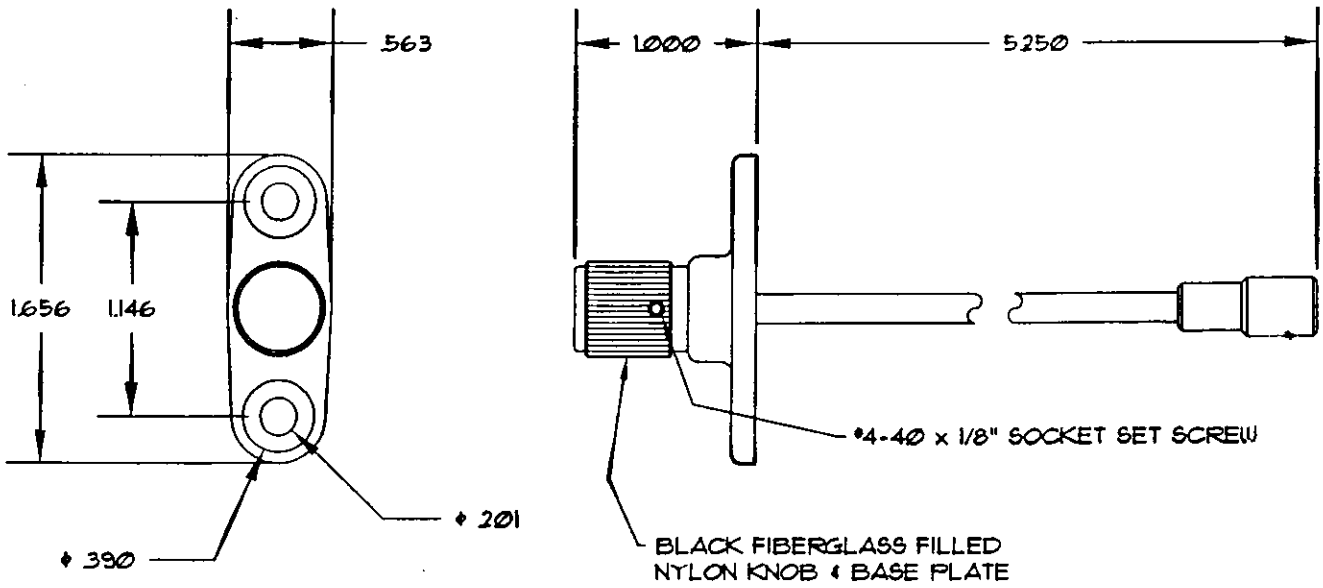
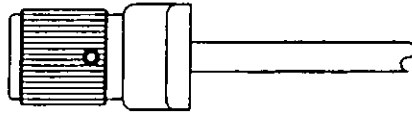

Standard Knob Operator

OEM Shades Inc. Warranty
P2100 and P2625 Series
Between the Glass Blind Systems

This warranty is extended to the original purchaser for a period of 10-years from the date of purchase of OEM Shades Inc., P2100 (1") and P2625 (5/8") Between the Glass Blind Systems. This warranty applies only to these products installed in between glass commercial applications.

OEM Shades Inc. will agree to repair or replace any part of our blind (s) at our discretion that is found to be defective in workmanship or materials without charge to the customer.

The blind (s) must be properly measured and installed per the instructions provided with the product. The customer must use the blind only as a window blind. This warranty covers only the original window in which the blind (s) has been installed.

To obtain service the customer will need to contact OEM Shades Inc. at the corporate offices located at 700 First Avenue, Ford City, PA, 16226. Advise OEM Shades of the product, date of purchase, original order number and a brief description of the problem. OEM Shades will review and contact the customer within 24 hours to provide instruction on repair or replacement.

The warranty does not cover damage caused by accidents, alterations, misuse, normal wear and tear, direct exposure to salty air or corrosive materials or color change that takes place with the passage of time. **Under no circumstances will OEM Shades Inc. be liable for incidental or consequential damages.** This warranty is extended in lieu of all other express warranties, whether oral or written.

This warranty provides specific legal rights. You may also have other legal rights which vary from state to state. Some states do not allow the exclusion or limitation of incidental or consequential damages. Therefore, the above limitation or exclusion may not apply.

ORDER FORM FOR P2
BETWEEN THE GLASS
ALUMINUM BLINDS



- 2100 Series (1") Metal Between Glass Blinds
- 2625 Series (5/8") Metal Between Glass Blinds

Page ___ of ___

Sold To:

Ship To:

Buyer:	Date:	PO#:
Phone:	Req. Ship Date:	Ship Via:

Line Item No.	Customer Item Number	Quantity	Blind Size in Inches		Slat Color	Control Rod Length	Cover Length if Applicable	Price Each	Total
			Width	Height					
1									
2									
3									
4									
5									
6									
7									
8									
9									
10									
11									
12									

Tilt Control Knobs <input type="checkbox"/> Standard Black #5005 Straight Knob <input type="checkbox"/> Black #5011 Removable Key Operator <input type="checkbox"/> Black #5038 Extended Straight Knob <input type="checkbox"/> Black #5044 Miniature Removable Key Operator

O-Ring Air Seal for Tilt Knot <input type="checkbox"/> With Rubber O-Ring <input type="checkbox"/> Without Rubber O-Ring	Control Rod Guides <input type="checkbox"/> #6001 Black Cover (must specify length above) <input type="checkbox"/> Not Required
---	--

End Caps <input type="checkbox"/> End Cap <input type="checkbox"/> Spring Loaded End Cap <input type="checkbox"/> Not Required	Mounting Hardware Snap in Clips Black <input type="checkbox"/> #2004 for 2100 Series <input type="checkbox"/> #2016 for 2625 Series <input type="checkbox"/> Not Required
--	--

SPECIAL NOTES:
